

POWER RAIL™

Top-Clamping PV Mounting System Catalog P6 and P8 Rails



 COMMUNICATIONS  ENERGY  SPECIAL INDUSTRIES  SOLAR

 **POWER-FAB®**
Quality Hardware for the PV Industry



POWER RAIL™ Module Mounting System



Top-clamping PV module mounting system engineered to reduce installation costs and provide maximum strength for parallel-to-roof or tilt up mounting applications.

The Power Rail top-clamping mounting system is designed with the professional PV solar installer in mind. The top-clamping rail utilizes a single tool with a revolutionary RAD™ Fastener for faster bolt placement. The unique shape of the RAD provides an anti-rotation feature, locking the bolt in the proper orientation when installed. The high

strength rigid rail also includes an integral wiring channel for securing cables and providing a professional finish. The system includes all of the mounting options from the Power Rail family, designed for secure and water tight attachments to any roof style.

Mounting Rail Options

P6 Engineered to save cost on shorter span applications

P8 Engineered for longer span and heavier snow conditions

* Reference Rail Span and Cantilever Charts on page 14.

Features

High Strength Reliable Design

- Engineered rail profiles for maximum strength-to-weight ratio
- Structural Aluminum rigid rail construction
- High Strength stainless steel module clamps and hardware

Reduced Installation Time and Costs

- Single Tool Assembly – all 5/16" hardware
- RAD Fastener for quick bolt placements anywhere along rail
- Under flange clamping option
- Tile Hooks
- Integral Wiring Channel for securing cables

- Standard lengths up to 27 feet eliminate costly rail splices
- Snap-In WEEB Integral module grounding option

Flexible Mounting Options

- Height adjustable "L" mounting feet
- Tilt Feet up to 10 degrees
- Solid Aluminum Power Post™ stanchions
- Easy Feet™ attachment anywhere on metal or composite roof decking
- PV Flashing hardware
- Telescoping and One-Piece Tilt Kits up to 65 degrees

Power Rail™ Extrusions

Power Rail is an engineered profile extrusion made from Series 6000 structural aluminum. Standard finish is mill-finish aluminum.



Power Rail P6– Extrusion

P6 Standard Lengths

Part #	P6-84	P6-126	P6-162	P6-204	P6-240	P6-282	P6-324
Length	84"	126"	162"	204"	240"	282"	324"
Weight Per Unit (lbs.)	5	7.5	9.5	12	14	16.5	19
Pricing per Quantities (Higher Volume Discount Available)							
1-19	44.00	65.00	83.00	103.00	120.00	139.00	158.00
20-39	42.00	63.00	80.00	99.00	116.00	134.00	152.00
40-59	41.00	60.00	77.00	96.00	111.00	129.00	146.00
60-79	40.00	59.00	74.00	92.00	107.00	124.00	140.00
80-99	38.00	56.00	72.00	88.00	103.00	119.00	135.00
100+	36.00	54.00	68.00	85.00	98.00	114.00	129.00



Power Rail P8– Extrusion

P8 Standard Lengths

Part #	P8-84	P8-126	P8-162	P8-204	P8-240	P8-282	P8-324
Length	84"	126"	162"	204"	240"	282"	324"
Weight Per Unit (lbs.)	7	10.5	13.5	17	20	23.5	27
Pricing per Quantities (Higher Volume Discount Available)							
1-19	68.00	100.00	128.00	159.00	184.00	214.00	243.00
20-39	65.00	97.00	123.00	153.00	178.00	206.00	234.00
40-59	63.00	93.00	119.00	147.00	171.00	198.00	225.00
60-79	61.00	90.00	114.00	142.00	164.00	191.00	216.00
80-99	58.00	86.00	110.00	136.00	158.00	183.00	207.00
100+	56.00	83.00	105.00	130.00	151.00	175.00	198.00

Power Rail™ Splice Plates

Splice Plates

Part #	Description	Quantity	Weight Per Unit (lbs.)	Price
P6-SPK	Splice Plate for P6	1-9	0.25	7.00
		10+		6.50
P8-SPK	Splice Plate for P8	1-9	0.40	8.00
		10+		7.50



Tilted "L" Feet

Part #	Description	Quantity	Weight Per Unit (lbs.)	Price
FF5	5° Front Foot	1-49	0.25	8.00
		50-99		7.50
		100+		7.00
BF5	5° Back Foot	1-49	0.50	12.00
		50-99		11.50
		100+		11.00
FF10	10° Front Foot	1-49	0.25	8.00
		50-99		7.50
		100+		7.00
BF10	10° Back Foot	1-49	0.75	16.00
		50-99		15.50
		100+		15.00



Telescoping Tilt Kits

P6 Low-Profile Telescoping Tilt Kits

Part #	Description	Quantity	Weight Per Unit (lbs.)	Price
P6-TL35	Telescoping legs that range from 20°–35°	1-49	9.0	135.00
		50-99		130.00
		100+		125.00
P6-TL45	Telescoping legs that range from 24°–45°	1-49	11.0	140.00
		50-99		135.00
		100+		130.00
P6-TL55	Telescoping legs that range from 28°–55°	1-49	13.0	145.00
		50-99		140.00
		100+		135.00
P6-TL65	Telescoping legs that range from 30°–65°	1-49	15.0	150.00
		50-99		145.00
		100+		140.00



P6 Low-Profile Telescoping Tilt Kit

P8 Low-Profile Telescoping Tilt Kits

Part #	Description	Quantity	Weight Per Unit (lbs.)	Price
P8-TL35	Telescoping legs that range from 20°–35°	1-49	10.0	155.00
		50-99		150.00
		100+		145.00
P8-TL45	Telescoping legs that range from 24°–45°	1-49	12.0	160.00
		50-99		155.00
		100+		150.00
P8-TL55	Telescoping legs that range from 28°–55°	1-49	14.0	165.00
		50-99		160.00
		100+		155.00
P8-TL65	Telescoping legs that range from 30°–65°	1-49	16.0	170.00
		50-99		165.00
		100+		160.00



P8 Low-Profile Telescoping Tilt Kit

Note: Telescoping Tilt Kits include 3.5" L-feet, Strongback, Telescoping leg, and Rail-to-Rail brackets.

One-Piece Tilt Kits

P6 Low-Profile One-Piece Tilt Kits

Part #	Description	Quantity	Weight Per Unit (lbs.)	Price
P6-OP15	One-Piece legs for a 15° tilt	1-49	6.5	85.00
		50-99		81.50
		100+		78.00
P6-OP25	One-Piece legs for a 25° tilt	1-49	7.0	90.00
		50-99		86.50
		100+		83.00
P6-OP35	One-Piece legs for a 35° tilt	1-49	7.5	95.00
		50-99		91.50
		100+		88.00
P6-OP45	One-Piece legs for a 45° tilt	1-49	8.0	100.00
		50-99		96.50
		100+		93.00
P6-OP55	One-Piece legs for a 55° tilt	1-49	8.5	105.00
		50-99		101.50
		100+		98.00
P6-OP65	One-Piece legs for a 65° tilt	1-49	9.0	110.00
		50-99		106.50
		100+		103.00



P6 Low-Profile One-Piece Tilt Kit

P8 Low-Profile One-Piece Tilt Kits

Part #	Description	Quantity	Weight Per Unit (lbs.)	Price
P8-OP15	One-Piece legs for a 15° tilt	1-49	7.5	105.00
		50-99		101.50
		100+		98.00
P8-OP25	One-Piece legs for a 25° tilt	1-49	8.0	110.00
		50-99		106.50
		100+		103.00
P8-OP35	One-Piece legs for a 35° tilt	1-49	8.5	115.00
		50-99		111.50
		100+		108.00
P8-OP45	One-Piece legs for a 45° tilt	1-49	9.0	120.00
		50-99		116.50
		100+		113.00
P8-OP55	One-Piece legs for a 55° tilt	1-49	9.5	125.00
		50-99		121.50
		100+		118.00
P8-OP65	One-Piece legs for a 65° tilt	1-49	10.0	130.00
		50-99		126.50
		100+		123.00



P8 Low-Profile One-Piece Tilt Kit

Note: One-Piece Tilt Kits include 3.5" L-feet, Strongback, One-Piece leg, and Rail-to-Rail brackets.

Module Clamps

Module Clamps are Type 304 stainless steel for higher yield strength and durability. The low profile design and slim 3/8" gap between modules provide a professional appearance and higher module density.

RAD™ Hardware

RAD End Clamp	Part #	Description	Quantity	Weight Per Unit (lbs.)	Price
 End Clamp w/RAD Bolt	EC- <input type="text"/> -RAD	Module End Clamp w/RAD Hardware	1-19	0.15	5.25
			20-39		5.05
			40-59		4.85
			60-79		4.65
			80-99		4.45
			100+		4.25

Note: Replace with module depth from the Solar Module Depth Reference Chart at www.power-fab.com.
Example: EC-46-RAD end clamp for Sharp NU-U240F1 modules

Add "B" suffix to part number for black powder coat.
Example: EC-46-RAD-B. (Add 25% to price)

RAD Mid Clamp	Part #	Description	Quantity	Weight Per Unit (lbs.)	Price
 Mid Clamp w/RAD Bolt	MC-28-33-RAD	Module Mid Clamp for 28-33 mm Thick Frame	1-49	0.08	4.50
			50-99		3.75
			100+		3.25
	MC-34-39-RAD	Module Mid Clamp for 34-39 mm Thick Frame	1-49		4.50
			50-99		3.75
			100+		3.25
	MC-40-46-RAD	Module Mid Clamp for 40-46 mm Thick Frame	1-49		4.50
			50-99		3.75
			100+		3.25
	MC-47-52-RAD	Module Mid Clamp for 47-52 mm Thick Frame	1-49		4.50
			50-99		3.75
			100+		3.25
	MC-53-59-RAD	Module Mid Clamp for 53-59 mm Thick Frame	1-49		4.50
			50-99		3.75
			100+		3.25

Carriage Bolt Hardware

End Clamp	Part #	Description	Quantity	Weight Per Unit (lbs.)	Price
 End Clamp w/Carriage Bolt	EC- <input type="text"/> -CAR	Module End Clamp w/Carriage Bolt Hardware	1-19	0.15	5.25
			20-39		5.05
			40-59		4.85
			60-79		4.65
			80-99		4.45
			100+		4.25

Note: Replace with module depth from the Solar Module Depth Reference Chart at www.power-fab.com.
Example: EC-46-CAR end clamp for Sharp NU-U240F1 modules

Add "B" suffix to part number for black powder coat.
Example: EC-46-RAD-B. (Add 25% to price)

Mid Clamp	Part #	Description	Quantity	Weight Per Unit (lbs.)	Price
 Mid Clamp w/Carriage Bolt	MC-28-33-CAR	Module Mid Clamp for 28-33 mm Thick Frame	1-49	0.08	4.50
			50-99		3.75
			100+		3.25
	MC-34-39-CAR	Module Mid Clamp for 34-39 mm Thick Frame	1-49		4.50
			50-99		3.75
			100+		3.25
	MC-40-46-CAR	Module Mid Clamp for 40-46 mm Thick Frame	1-49		4.50
			50-99		3.75
			100+		3.25
	MC-47-52-CAR	Module Mid Clamp for 47-52 mm Thick Frame	1-49		4.50
			50-99		3.75
			100+		3.25
	MC-53-59-CAR	Module Mid Clamp for 53-59 mm Thick Frame	1-49		4.50
			50-99		3.75
			100+		3.25

Universal End Clamp

Part #	Description	Quantity	Weight Per Unit (lbs.)	Price
P6-ECU	Universal End Clamp w/Set Bolt for P6	1-49	0.15	9.00
		50-99		8.50
		100+		8.00
P8-ECU	Universal End Clamp w/Set Bolt for P8	1-49	0.25	10.00
		50-99		9.50
		100+		9.00

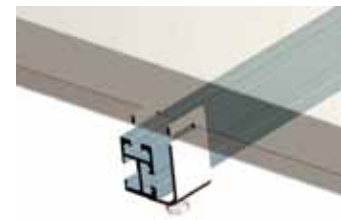

“L” Feet

“L” Feet are fabricated from high strength 3/16" aluminum and include a vertical slot for adjusting to irregular surfaces.

Part #	Description	Quantity	Weight Per Unit (lbs.)	Price
LF2	2.5" Tall L-Mounting Foot	1-49	0.20	7.00
		50-99		6.50
		100+		6.00
LF3	3.5" Tall L-Mounting Foot	1-49	0.24	9.00
		50-99		8.50
		100+		7.00
LF5	5" Tall L-Mounting Foot	1-49	0.40	10.00
		50-99		9.25
		100+		8.50
LF6	6" Tall L-Mounting Foot	1-49	0.45	12.00
		50-99		11.00
		100+		9.75
PPB	Power Post Bracket	1-49	.09	6.50
		50-99		6.00
		100+		5.50



Easy Feet™

Easy Feet mount directly to metal and composite shingles or other roofing materials and do not require attachment to a roof structural member. Sealing butyl mastic backing and RSS PHEinox™ screws are included.

Part #	Description	Quantity	Weight Per Unit (lbs.)	Price
PEF-1.5	Pivot Easy Mounting Foot w/1.5" Screws	1-49	0.76	21.50
		50-99		20.50
		100+		19.00
PEF-2.0	Pivot Easy Mounting Foot w/2.0" Screws	1-49	0.78	22.00
		50-99		21.00
		100+		19.50
PEF-3.0	Pivot Easy Mounting Foot w/3.0" Screws	1-49	0.82	23.00
		50-99		22.00
		100+		20.50



RSS PHEinox™ screws are manufactured by GRK Fasteners.

Corrugated Roof Mounts

Part #	Description	Quantity	Price
CMB	Mounting Bridge to Span Peaks of Corrugated Metal Roofs	1-49	13.50
		50-99	12.50
		100+	11.00

Note: Not all corrugated metal roofs are the same. Please contact DPW Solar to design mounting bridges that are specific to your application. Pricing subject to change. L-Foot not included.

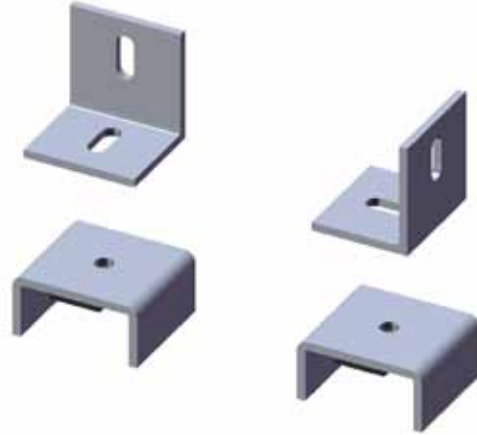

Roof Rod Mount

Roof Rod mounts attach directly to the roof deck and are suitable for tile and other roofing materials. Simply, drill a hole through the roofing material. Sealing butyl mastic backing and RSS PHEinox™ screws included.

Part #	Description	Quantity	Weight Per Unit (lbs.)	Price
RRM	Threaded Rod Mount	1-49	1.5	30.00
		50-99		29.00
		100+		27.50

Note: L Foot included.



RSS PHEinox™ screws are manufactured by GRK Fasteners.

(800) 260.3792



www.DPWSolar.com

Power Post™ Stanchions

Power posts offer high strength solid aluminum construction and are used with flashing cones.

Part #	Description	Diameter	Quantity	Weight Per Unit (lbs.)	Price
PP3	3" Power Post	1.31"	1-49	0.55	20.50
			50-99		19.50
			100+		18.00
PP4	4" Power Post	1.31"	1-49	0.67	21.00
			50-99		20.00
			100+		18.50
PP5	5" Power Post	1.31"	1-49	0.81	21.50
			50-99		20.50
			100+		19.00
PP6	6" Power Post	1.31"	1-49	0.94	22.00
			50-99		21.00
			100+		19.50
PP7	7" Power Post	1.31"	1-49	1.1	22.50
			50-99		21.50
			100+		20.00

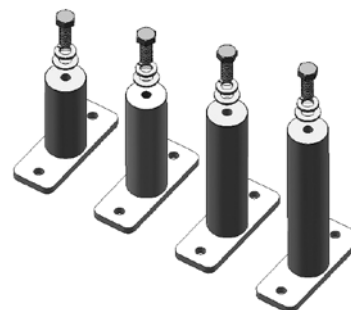

Super Post™ Stanchions

Super posts offer high strength solid aluminum construction for larger arrays and higher roof clearance.

Part #	Description	Diameter	Quantity	Weight Per Unit (lbs.)	Price
SP7	7" Super Mounting Post	1.75"	1-49	2.4	40.50
			50-99		37.50
			100+		34.50
SP8	8" Super Mounting Post	1.75"	1-49	2.6	42.00
			50-99		39.00
			100+		36.00
SP9	9" Super Mounting Post	1.75"	1-49	2.9	43.50
			50-99		40.50
			100+		37.50
SP10	10" Super Mounting Post	1.75"	1-49	3.2	45.00
			50-99		42.00
			100+		39.00

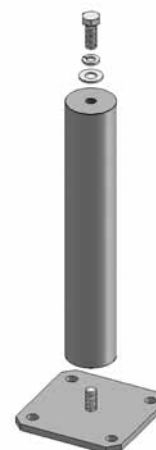

Easy Power Post™ Stanchions

Part #	Description	Diameter	Quantity	Weight Per Unit (lbs.)	Price
EP3	3" Easy Post	1.31"	1-49	0.82	25.00
			50-99		24.00
			100+		22.50
EP4	4" Easy Post	1.31"	1-49	0.94	25.50
			50-99		24.50
			100+		23.00
EP5	5" Easy Post	1.31"	1-49	1.08	26.00
			50-99		25.00
			100+		23.50
EP6	6" Easy Post	1.31"	1-49	1.21	26.50
			50-99		25.50
			100+		24.00
EP7	7" Easy Post	1.31"	1-49	1.37	27.00
			50-99		26.00
			100+		24.50

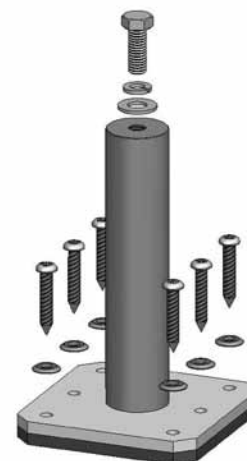

RSS PHEinox™ screws are manufactured by GRK Fasteners.

Offset Power Post™ Stanchions

Offset Power Posts center the flashing cone and avoid potential gaps with the Power Post base.

Part #	Description	Diameter	Quantity	Weight Per Unit (lbs.)	Price
OP3	3" Offset Mounting Post	1.31"	1-49	0.55	20.50
			50-99		19.50
			100+		18.00
OP4	4" Offset Mounting Post	1.31"	1-49	0.67	21.00
			50-99		20.00
			100+		18.50
OP5	5" Offset Mounting Post	1.31"	1-49	0.81	21.50
			50-99		20.50
			100+		19.00
OP6	6" Offset Mounting Post	1.31"	1-49	0.94	22.00
			50-99		21.00
			100+		19.50
OP7	7" Offset Mounting Post	1.31"	1-49	1.1	22.50
			50-99		21.50
			100+		20.00



(800) 260.3792

POWER-FAB®

www.DPWSolar.com

Power Rail™ Accessories

Power Rail™ PV Flash

Power Rail PV Flash includes one universal slotted compression block, and one 8" x 12" flashing in matte, black color.

Part #	Attachment Hardware	Qty.	Shipping Weight Per Unit (lbs.)	Price
PFU*	5/16" x 5" hangerbolt	10-49	0.80	14.00
		50-99		13.00
		100+		11.50
PVU*	Stainless Steel Base Plate and 3" Fasteners	10-49	1.00	16.00
		50-99		15.00
		100+		13.50

*MUST order in quantities of 10

Power Rail accessories are non-discountable products

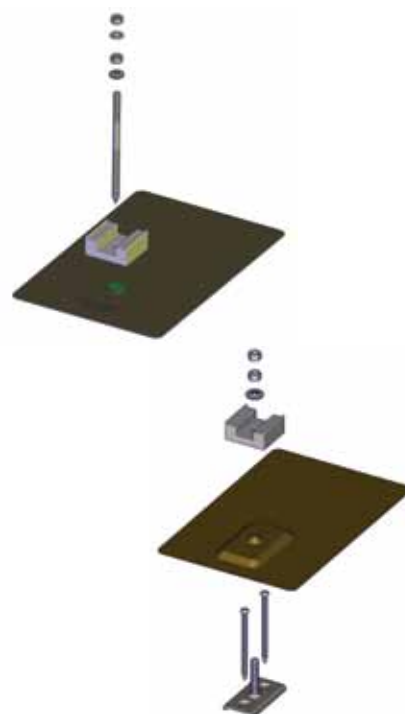

Power Post Flashing

Part #	Attachment Hardware	Qty.	Weight Per Unit (lbs.)	Price
OF*	Oatey Flashing with Rubber Boot for 1.31" posts	12-47	0.66	5.15
		48-95		4.40
		96+		3.90
SMF*	Aluminum One Piece Flashing	12-47	1.15	10.40
		48-95		8.90
		96+		7.85
RFC*	Rubber Flashing Collar	12-47	0.05	2.00
		48-95		1.75
		96+		1.55

NOTE: Oatey No-Calk® NC-1 Solar flashing are galvanized with a UV Rubber Boot that fits onto the Power Post. Oatey flashing may be used on roofs with 0-45 degree angles.

*MUST order in quantities of 12

Power Rail accessories are non-discountable products

No-Calk® is a registered trademark of Oatey Co.



Power Rail™ Accessories

Flat Roof Flashing

Part #	Description	Quantity	Weight Per Unit (lbs.)	Price
LPK4*	4" Lockin' Pocket	6-47	1.7	15.50
		48-95		14.50
		96+		13.50
LPK6**	6" Lockin' Pocket	4-47	2.6	23.00
		48-95		21.50
		96+		20.50
HFUS	Hurricane Force Universal Sealer	1	-	27.75
BPAG	Battery Powered Applicator Gun	1	-	690.00

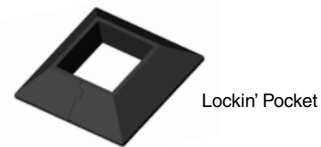

Lockin' Pocket

NOTE: Lockin' Pockets and Hurricane Force Sealer are backed by a third party warranty on all flat roof penetrations.

*MUST order in quantities of 6

**MUST order in quantities of 4

Power Rail accessories are non-discountable products

Grounding Hardware

Part #	Description	Quantity	Weight Per Unit (lbs.)	Price
WEEB-DPF*	Module Grounding Clip	10-99	.003	1.50
		100-999		1.10
		1000+		.90
WEEB-11.5*	Splice Plate Grounding Clip	10-99	.003	1.50
		100-999		1.10
		1000+		.90
WEEBL-8.0*	Rail Grounding Lug	10-99	0.19	5.65
		100+		4.65
WEEB-8.0-RBJ*	Rail Bonding Jumper	10-99	0.11	7.80
		100+		6.45
ACC-PV*	ACME PV Cable Clip	10-99	0.006	.52
		100-999		.41
		1000+		.33
ACC*	ACME – 2 Cable Clip	10-99	0.006	.52
		100-999		.41
		1000+		.33

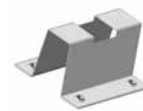

WEEB-DPF Module Grounding Clip



WEEB 11.5



WEEB Rail Grounding Lug



Rail Bonding Jumper



ACME Cable Clip

NOTE: Cable Clips snugly hold 1 or 2 designated cables.

*MUST order in quantities of 10

Power Rail accessories are non-discountable products

Rail Span and Cantilever Distances

P6 Rail Span and Cantilever Distances (inches)

	SPAN/C'VER	SNOW LOAD (PSF)										
		0	10	20	30	40	50	60	70	80	90	100
WIND SPEED (MPH)*	90	72/36	60/32	54/26	48/24	43/21	40/20	36/18	33/16	31/15	29/14	28/14
	100	60/32	58/28	48/24	46/23	42/21	38/19	36/18	33/16	31/15	29/14	28/14
	110	58/28	54/26	48/24	44/22	40/20	37/18	35/17	33/16	31/15	29/14	28/14
	120	54/26	54/26	46/23	42/21	39/19	36/18	34/17	32/16	31/15	29/14	28/14
	130	48/24	48/24	44/22	40/20	37/18	35/17	33/16	32/16	30/15	29/14	28/14

* Exposure C Category Only

Please refer to design guidelines and ASCE requirements for more information.

P8 Rail Span and Cantilever Distances (inches)

	SPAN/C'VER	SNOW LOAD (PSF)										
		0	10	20	30	40	50	60	70	80	90	100
WIND SPEED (MPH)*	90	96/48	92/46	80/40	72/36	66/33	62/31	58/29	52/26	50/25	46/23	44/22
	100	88/44	86/43	76/38	68/34	64/32	60/30	56/28	52/26	50/25	46/23	44/22
	110	80/40	80/40	72/36	66/33	62/31	58/29	54/27	52/26	50/25	46/23	44/22
	120	74/37	74/37	68/34	64/32	60/30	56/28	52/26	50/25	48/24	46/23	44/22
	130	68/34	68/34	66/33	60/30	56/28	54/27	52/26	48/24	46/23	44/22	44/22
	140	64/32	64/32	62/31	58/29	54/27	52/26	50/25	48/24	46/23	44/22	42/21
	150	60/30	60/30	60/30	56/28	52/26	50/25	48/24	46/23	44/22	42/21	42/21

* Exposure C Category Only

Please refer to design guidelines and ASCE requirements for more information.



DPW | SOLAR



PREFORMED LINE PRODUCTS

Direct Power & Water Corporation
4000-B Vassar Drive NE
Albuquerque, New Mexico 87107 USA

Telephone: 505.889.3585
Toll Free: (800) 260.3792
Fax: 505.889.3548
Web site: www.DPWSolar.com
Email: info@power-fab.com

© 2011 Preformed Line Products
Printed in U.S.A.
SL-ML-1034-3P
10.11.00